

**TEMPORARY TIMBER BARRICADE**  
FOR TYPICAL CONDITIONS

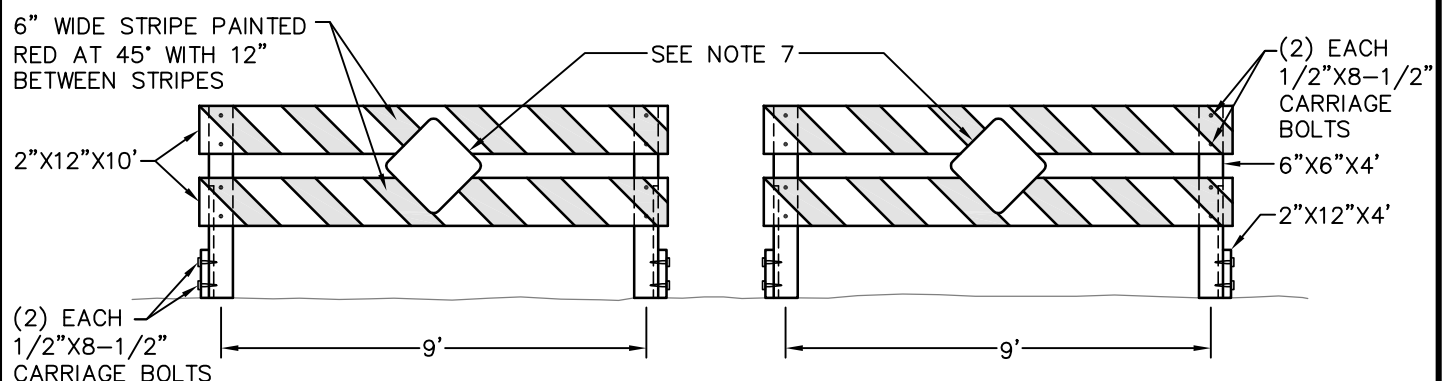

**PORTABLE TIMBER BARRICADE**  
FOR SPECIAL CONDITIONS

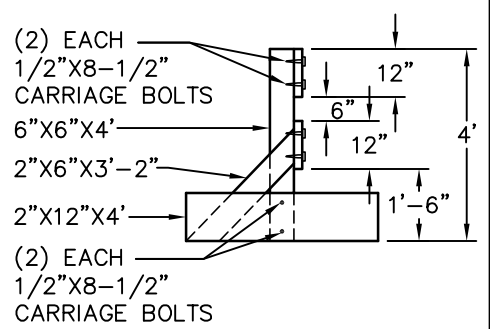

**PORTABLE TIMBER BARRICADE**  
SIDE VIEW

**NOTES:**

1. BARRICADES SHALL BE FULL WIDTH OF PAVEMENT OR TRAVELED WAY OR AS APPROVED BY THE CITY ENGINEER.
2. BARRICADE SHALL BE PAINTED WITH TWO COATS OF WHITE PAINT. FOLLOWED BY TWO COATS OF RED PAINT FOR THE STRIPE. PAINT SHALL BE A PREMIUM QUALITY EXTERIOR GLOSS OR SEMI-GLOSS ENAMEL AND SHALL BE PURE WHITE IN COLOR. PAINT SHALL COMPLETELY SEAL ALL EXPOSED SURFACES OF THE BARRICADE.
3. WOOD PRESSURE TREATED WITH A PRESERVATIVE MAY BE SUBSTITUTED FOR REDWOOD MATERIAL.
4. ALL SIGNS SHALL BE IN ACCORDANCE WITH THE CURRENT EDITION OF THE CALIFORNIA MANUAL OF UNIFORM TRAFFIC CONTROL DEVICES.
5. USE OF THE PORTABLE TIMBER BARRICADE OR BARRICADES WITH A LOCK AND CHAIN, SHALL BE SUBJECT TO THE APPROVAL OF THE CITY ENGINEER.
6. ABANDONED BARRICADES SHALL BE RECLAIMED BY THE CITY OF VISALIA.
7. REFLECTOR SIGNS - CALIFORNIA OM4-1. FASTEN REFLECTOR SIGN TO BARRICADE WITH 3/8" X 1-1/2" GALVANIZED LAG SCREWS WITH WASHERS.
8. DIAGONAL STRIPES ON BARRICADE SHALL POINT TO THE CENTER OF THE ROADWAY.

APPROVED BY:  09/16/16  
CITY ENGINEER R.P.E. 81734 DATE

**CITY OF VISALIA**  
**DESIGN & IMPROVEMENT STANDARDS**

**TIMBER BARRICADES**

REVISIONS
06/14/13
BK 2016

**B-1**